

Tates Creek High School
PERCUSSION Unit Entrance/Exit and Timeline

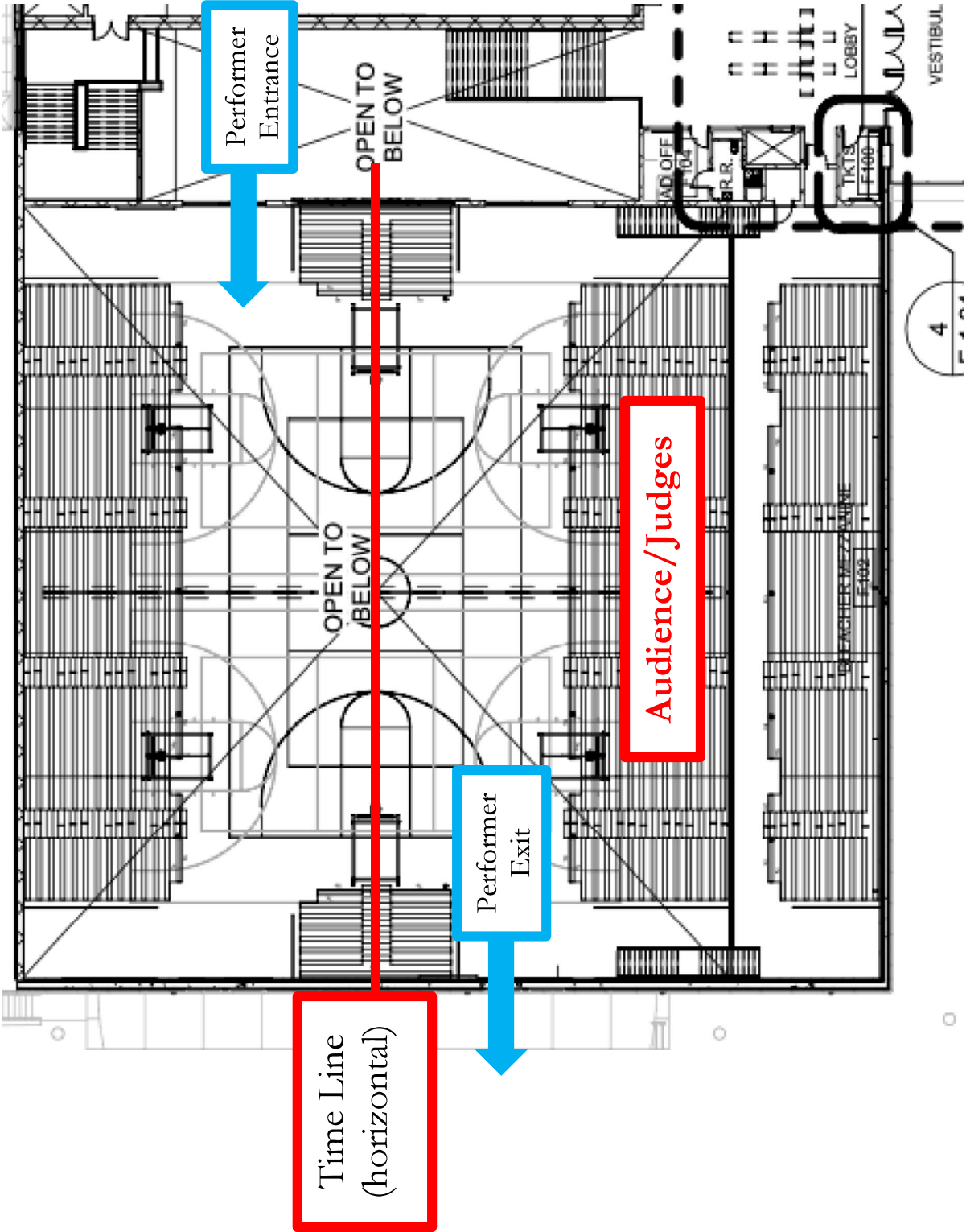

Tates Creek High School
GUARD Unit Entrance/Exit and Timeline

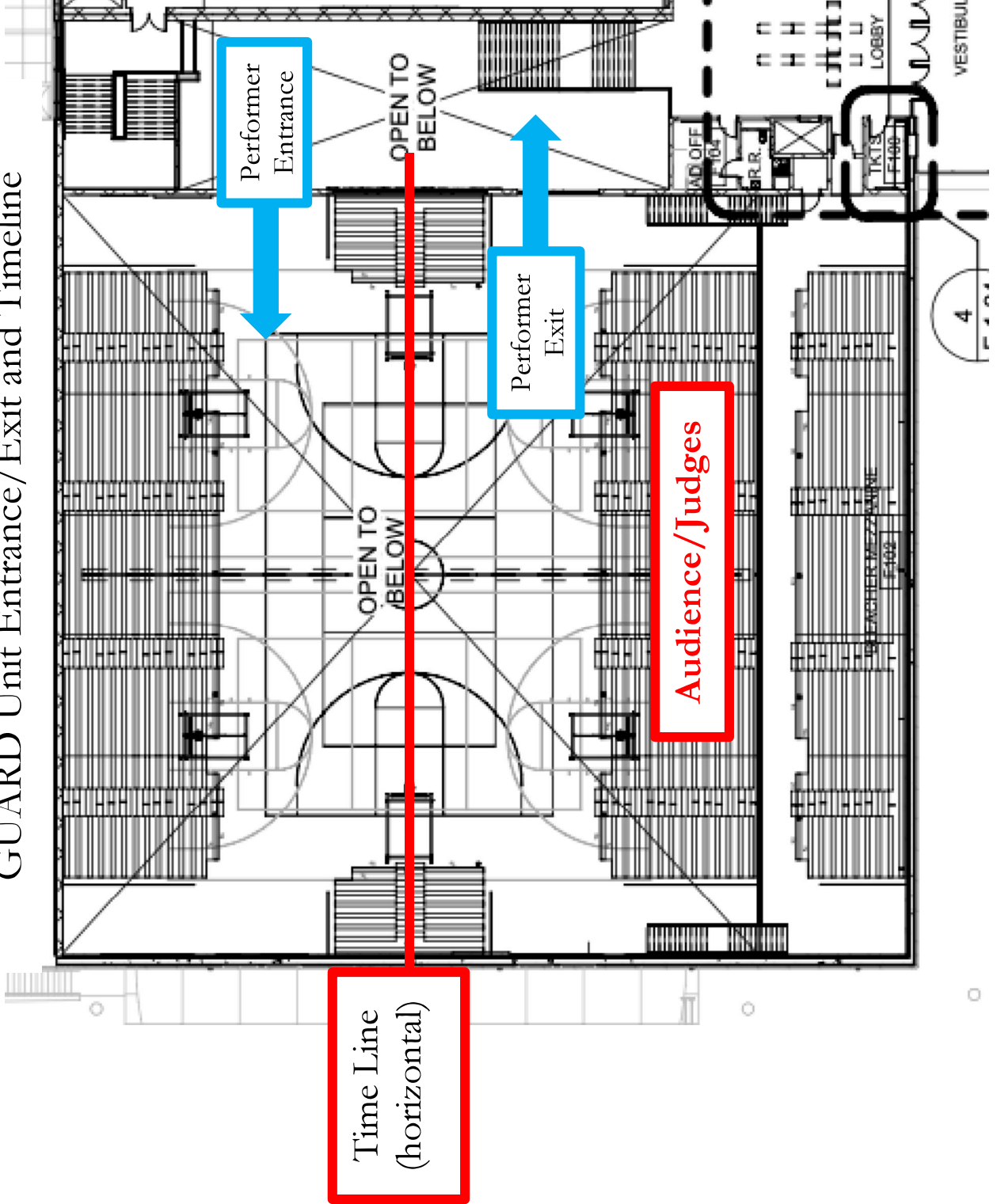



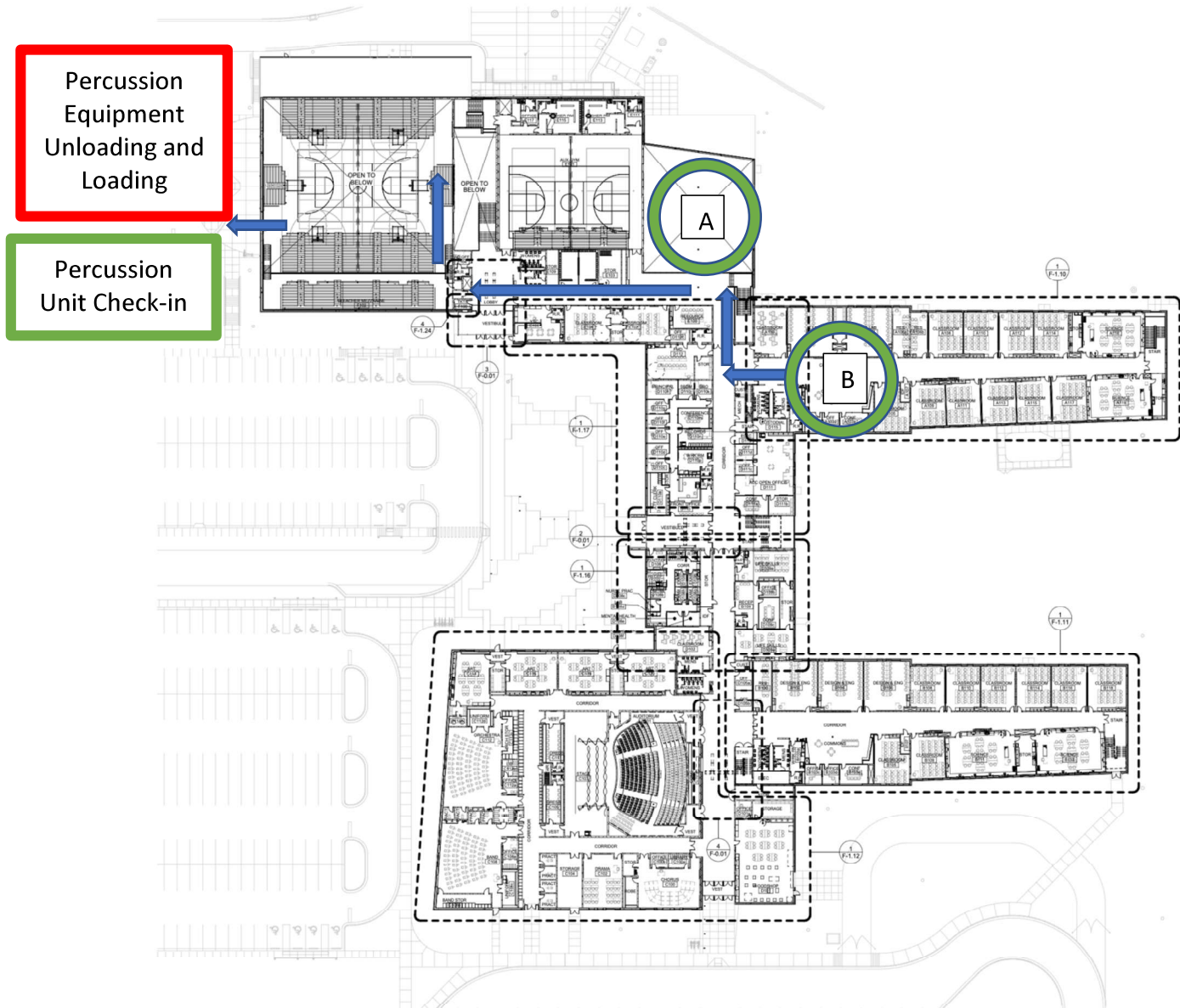



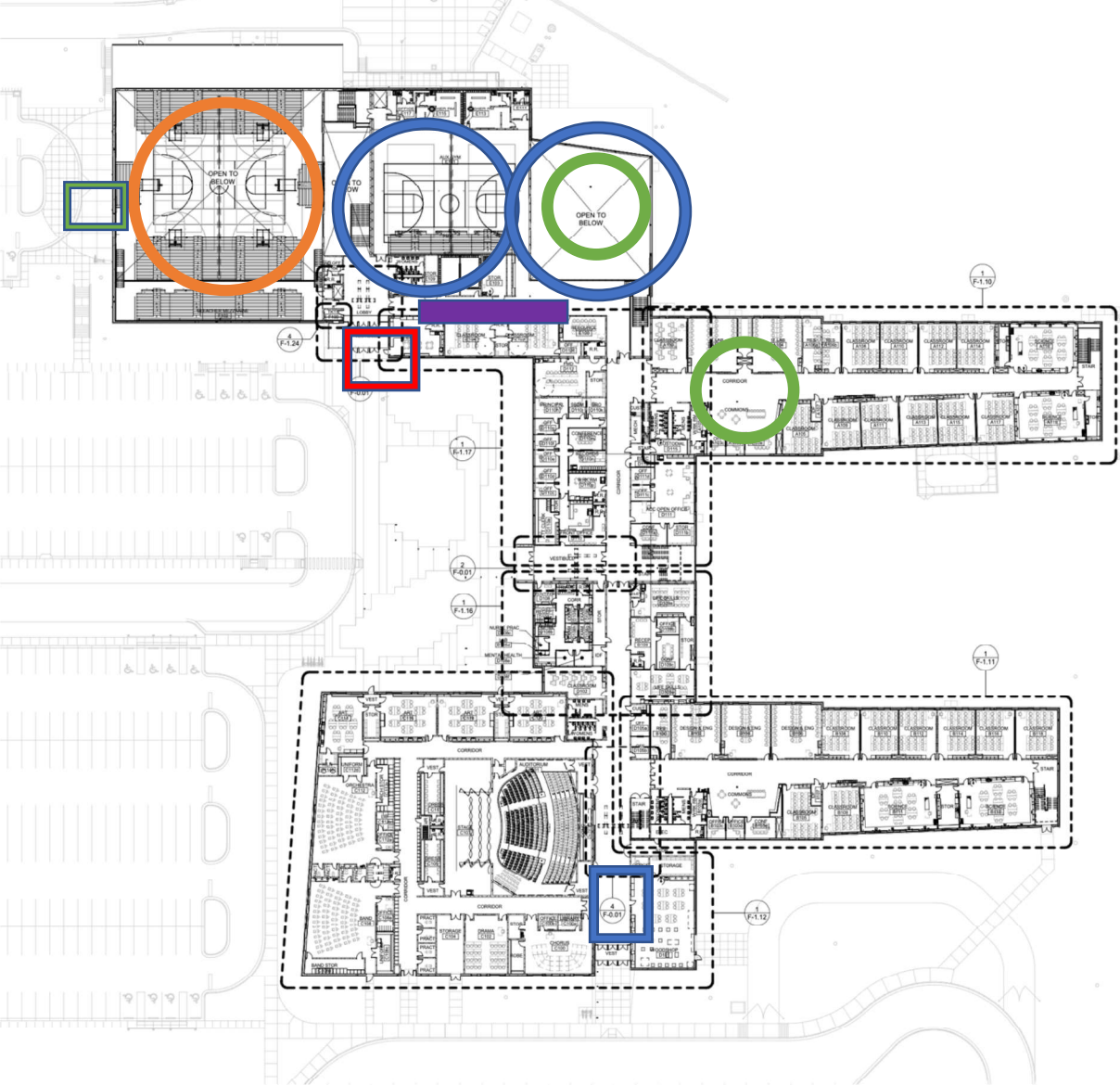

Tates Creek HS Percussion Equipment/Path Details



- Percussion will unload at the gym side doors and push to warm-up
- After warm-up, percussion will push through the building to the gym.
- After performance, percussion will exit through gym side doors directly to the loading zone.

Tates Creek High School Map



	Guard Unit Check-in
	Spectator Entrance
	Performance Gym
	Guard Warm-up
	Percussion Warm-up
	Tarp/Prop Staging
	Percussion Unit Check in and Equipment Entrance