



|  |   |
|--|---|
| <b>Place:</b>                          | Corydon Central HS  |
| <b>Date:</b>                           | March 14, 2020  |
| <b>Time:</b>                           | 12:00PM   |
| <b>Directions</b>                      | From I-64: Take exit 105 and turn right towards Corydon. Turn left on SR337 and follow through downtown. Turn left on Laconia Rd (still SR337). Turn left on Country Club Road. The High School will be on the right. Take the second entrance and follow the signs for spectator parking or bus/truck parking. Student drop off will be at door #9.        |
| <b>Doors:</b>                          | Doors will open at approximately at 10:00 AM. Booster sales people from the units that want to display should bring their own tables for use. There are 50 spaces (10'X10') available for vendors. Please contact show sponsor. Space is limited. Contact Sarah Ground at <a href="mailto:grounds@shcsc.k12.IN.us">grounds@shcsc.k12.IN.us</a> 502-494-9585 |
| <b>Phone Number for day of contest</b> | Chris Wells 812-968-4262  |
| <b>Contest director</b>                | Angie Campbell 859-982-4913   |
| <b>Admission:</b>                      | \$9.00<br>Children 6 and under no charge  |

**Unit Managers:** It is suggested that you have your unit sign in together at the designated door.. Back up CDs of performance music are recommended. All music will be downloaded for the event from Competition Suite. It's the unit directors responsibility to keep your units music updated on the Competition Suite website.

- Upon arrival at a contest, unit managers or representatives are to immediately sign in at the registration desk. You can access your judges commentary thru [www.competitionsuite.com](http://www.competitionsuite.com).
- All performing members and **eight** additional staff members will be admitted at check-in. Each staff person will be stamped for front side. This must be done as a group admission
- All equipment is taken to the assigned area. Make sure to keep your equipment neat and organized in the hallway provided.
- Absolutely no cooking or smoking in any of the buildings that are used for the competition

**Visual Recording:** TriState does not allow video taping of any unit. It is your responsibility to pass this information on to your parents and students.

COMPETITION AREA ENTRANCE & EXIT DIAGRAM

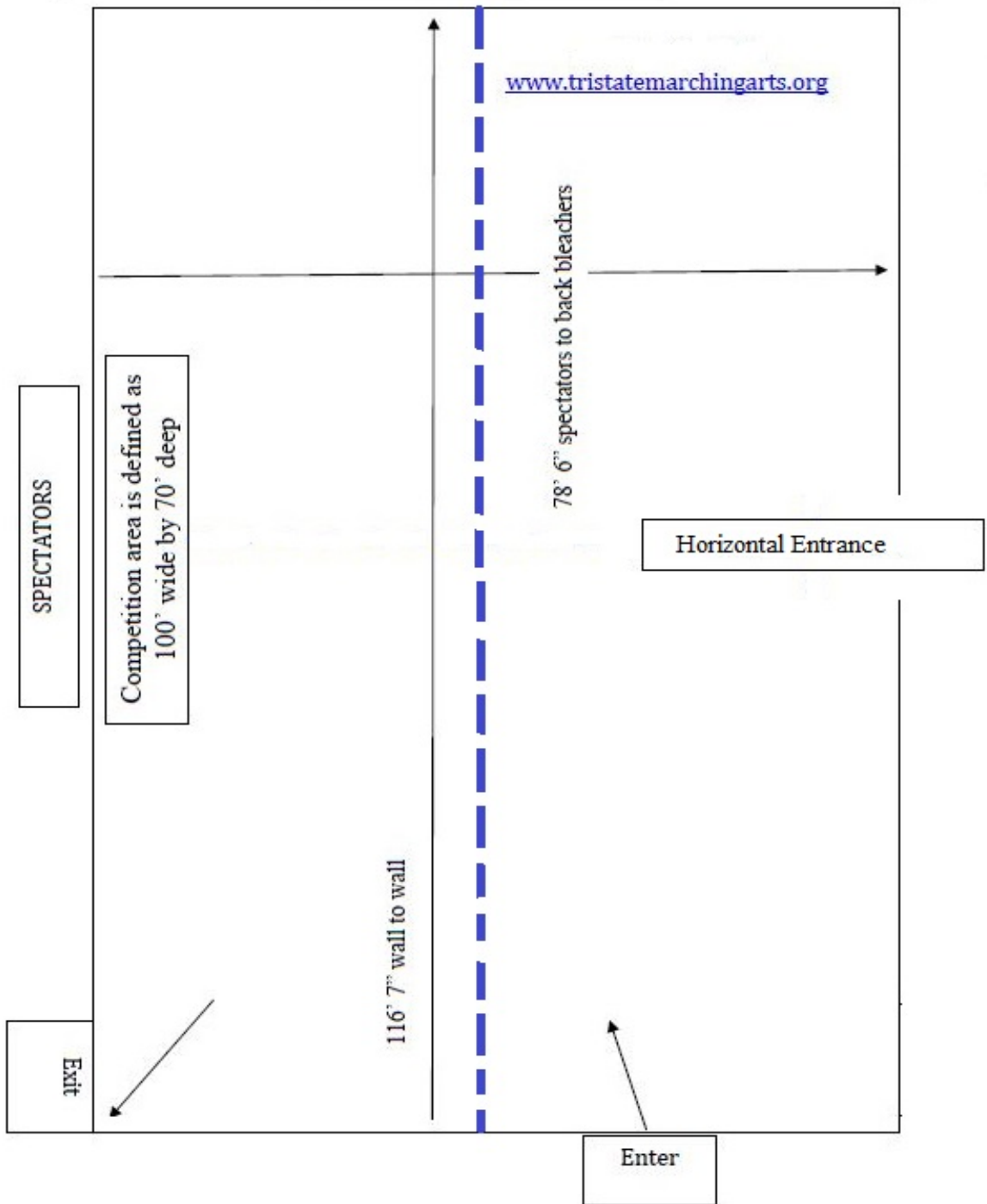

as of 3/2/2020

[www.tristatemarchingarts.org](http://www.tristatemarchingarts.org)