



# TRI-STATE

## MARCHING ARTS

<b>Place:</b>	<a href="#">Conner HS – 3310 Cougar Path - Hebron, KY</a>
<b>Date:</b>	February 17, 2018
<b>Time:</b>	12:00 PM
<b>Directions</b>	I-75 to I-275 West. Take the Hebron Rt. 237 South exit. Go through 3 traffic lights. Just past the 6 <sup>th</sup> light turn left onto Cougar Path. At stop sign go straight ahead, past the Junior. High and follow signs for parking.
<b>Doors:</b>	Doors will open at approximately at 10:00 AM. Booster sales people from the units that want to display should bring their own tables for use. Some tables may be provided if available. Please contact show sponsor. Space is limited. Contact Hannah Hilgefurd 937-361-2087
<b>Phone Number for day of contest</b>	Hannah Hilgefurd 937-361-2087
<b>Contest director</b>	Chris Thomas 513-235-4981
<b>Admission:</b>	\$9.00 Adults Children 6 and under no charge.

**Unit Managers:** It is suggested that you have your unit sign in together at the designated door. Please turn in your Music at guard check in. Back up CDs are recommended. Make sure all CDs are clearly marked. All Music will be downloaded and used for the whole season. Its responsibility to keep your units music updated

- Upon arrival at a contest, unit managers or representatives are to immediately sign in at the registration desk. Turn in music if not on file. You can access your judges commentary thru [www.competitionsuite.com](http://www.competitionsuite.com). It is optional to turn in a Mp3 or jump drive for judges commentary
- All performing members and ten additional staff members will be admitted at check-in. Each staff person will be stamped for front side. This must be done as a group admission
- All equipment is taken to the assigned area. Make sure to keep your equipment neat and organized in the hallway provided.
- Absolutely no cooking or smoking in any of the buildings that are used for the competition

**Visual Recording:** TriState does not allow video taping of any unit. It is your responsibility to pass this information on to your parents and students.

as of 1/21/2018

[www.tristatemarchingarts.org](http://www.tristatemarchingarts.org)



# TRI-STATE MARCHING ARTS

Conner Flow Chart

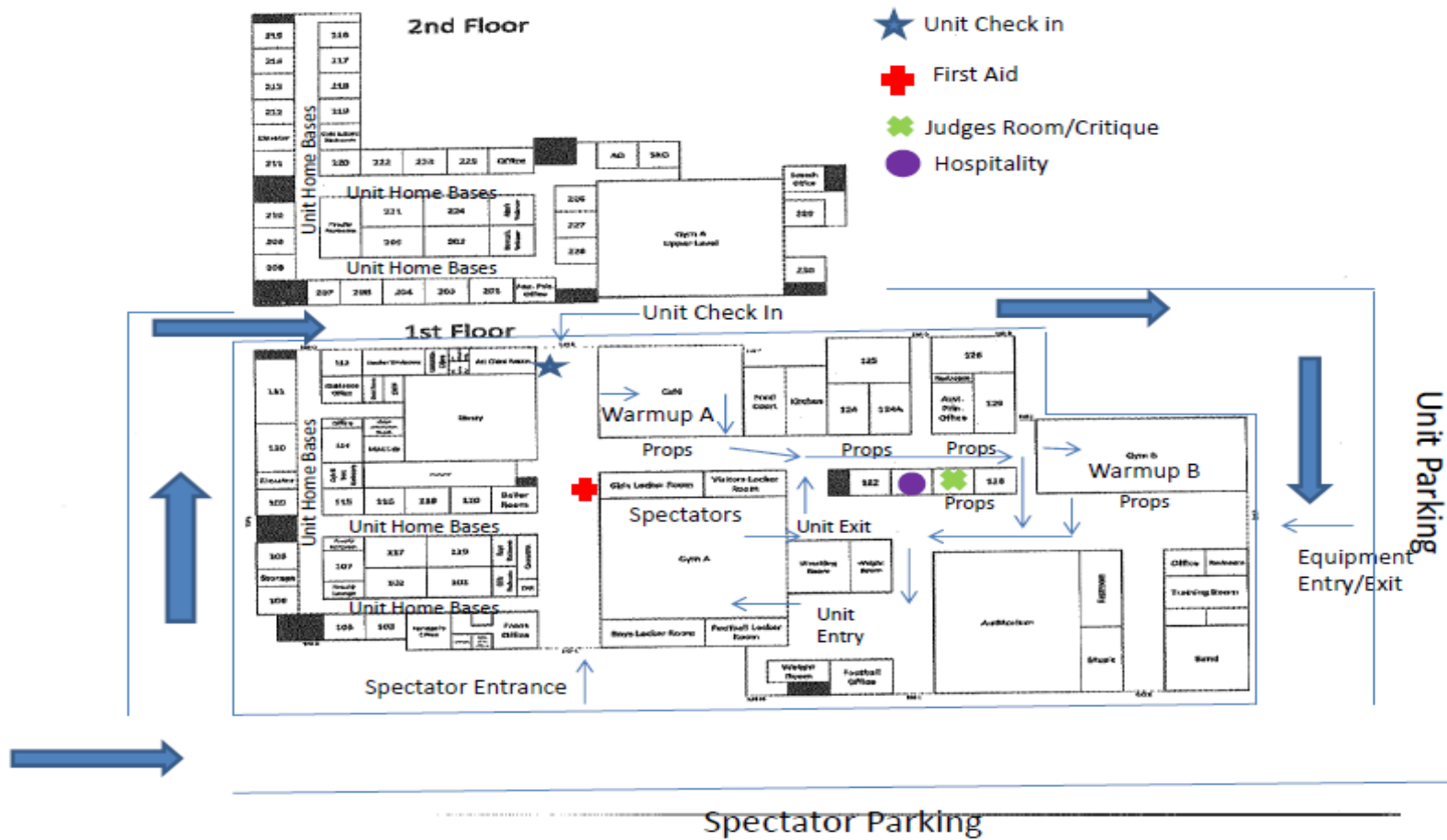

as of 1/21/2018

[www.tristatemarchingarts.org](http://www.tristatemarchingarts.org)



# TRI-STATE

## MARCHING ARTS

